

CHAPTER 14.25 SHORT-TERM RENTAL LAND USE REGULATIONS

14.25.005 Purpose

This chapter establishes criteria by which short-term rental uses may be permitted in order to ensure the safety and convenience of renters, owners, and neighboring property owners; protect the character of residential neighborhoods; protect the City's supply of needed housing; and address potential negative effects such as excessive noise, overcrowding, illegal parking, and nuisances (e.g. accumulation of refuse, light pollution, etc.).

It is the intent of these regulations to strike a reasonable balance between the need to limit short-term rental options within neighborhoods to ensure compatibility, while also recognizing the benefits of short-term rentals in providing recreation and employment opportunities, as well as transitional housing for tourists, employees of businesses, and others who are in need of housing for a limited duration.

(Staff note: the following definitions will be added to, or will update terms defined in Chapter 14.01. They are included here for reference.)

14.01.010 Definitions

The following definitions apply in this chapter.

- A. Authorized Agent. A property management company or other entity or person who has been designated by the owner to act on their behalf. An authorized agent may or may not be the designated point of contact for complaints.
- B. Bed and Breakfast Facility. A short-term rental where the operator resides on the premises and meals are provided for a fee on a daily or weekly room rental basis.
- C. Bedroom. A habitable room that (a) is intended to be used primarily for sleeping purposes; (b) contains at least 70-square feet; and (c) is configured so as to take the need for a fire exit into account.
- D. Dwelling Unit. A single unit providing complete independent living facilities for one or more persons, including permanent provisions for living, sleeping, eating, cooking and sanitation.
- E. Home share. A short-term rental, other than a Bed and Breakfast Facility, where a portion of a dwelling unit is rented

while the homeowner is present. For the purposes of this definition, “present” means the homeowner is staying in the dwelling overnight for the duration of the rental.

- F. Owner. Means the natural person(s) or legal entity that owns and holds legal or equitable title to the property.
- G. Short-Term Rental. A dwelling unit, or portion thereof, that is rented to any person on a day to day basis or for a period of less than thirty (30) consecutive nights.
- H. Street Segment. A portion of a local or collector street which is located between two intersections, or between an intersection and the end of a cul-de-sac or dead-end. *See Illustration: Illustrative Street Segments, below.*

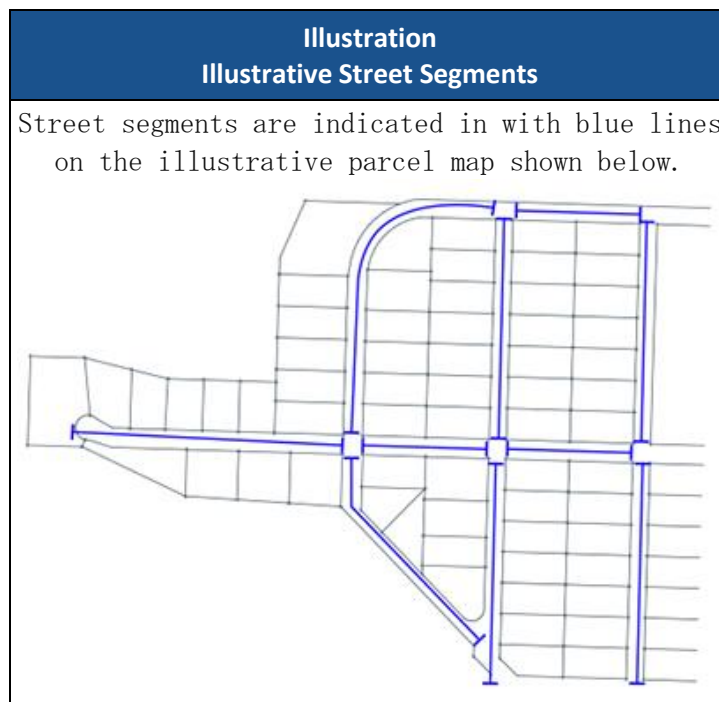

- I. Vacation Rental. A short-term rental where the entire dwelling unit is rented.

14.25.010 Approval Authority

- A. Upon receipt of a request by an owner or authorized agent to complete a land use compatibility statement for a short-term rental the Community Development Director, or designee, shall determine if the request satisfies the standards of section 14.25.030. If the request satisfies the standards, then the Director shall sign the statement confirming that short-term rental is a permitted use. Such action is ministerial and, as a non-discretionary act, is not subject to appeal.

- B. In the event that the Community Development Director or designee, determines that an application does not meet one or more of the standards of section 14.25.030, then the land use compatibility statement shall not be signed.
- C. If one or more of the standards under section 14.25.030 cannot be met, an owner may seek relief from those standards through a conditional use permitting process, pursuant to section 14.34.010. Such an application is subject to review by the Planning Commission via a Type III decision making process, consistent with section 14.52.010, and is to be limited in scope to those standards that cannot be satisfied.
- D. A Conditional Use Permit may authorize more than one building for vacation rental use on street segments where ten or more lots front the street. In such cases, no more than one building may be permitted for vacation rental use for every five lots fronting the street.
- E. An approved Conditional Use Permit that grants relief from, or provides alternative requirements to, one or more of the standards of section 14.25.030 shall serve as evidence that standards have been satisfied so that the Director can sign the land use compatibility statement.

14.25.015 Submittal Requirements

Land use compatibility statements shall be submitted on a form provided by the Community Development Department, and shall include the following:

- A. Site plan, drawn to scale, showing the dimensions, property lines, existing buildings, landscaped area, and off-street parking locations.
- B. Floorplan of the dwelling unit that identifies the rooms dedicated to short-term rental use.
- C. If the dwelling unit is within a residential zone, a calculation of the percentage of front yard and total lot area maintained in landscaping.
- D. If the dwelling unit relies upon shared parking areas, a copy of a covenant or other binding legal instrument detailing unit owner rights and responsibilities related to the parking areas.

14.25.020 Establishment of a Vacation Rental Overlay Zone

A Vacation Rental Overlay Zone is hereby established to identify areas within the city limits where vacation rentals are compatible uses and, by exclusion from the overlay, areas where vacation rentals are prohibited in order to protect the City's supply of needed housing and character of residential neighborhoods. The sole purpose of the Vacation Rental Overlay Zone is to identify where vacation rentals are permitted uses and does not alleviate a vacation rental from having to satisfy requirements that are otherwise applicable under the Newport Municipal Code.

The Vacation Rental Overlay Zone shall be indicated on the Zoning Map of the City of Newport with the letters VROZ and is the area described as follows:

Real property lying within the corporate limits of the City of Newport beginning at the southwest corner of the intersection of NW 12th Street and US 101; thence west along the south line of NW 12th Street to the statutory beach line of the Pacific Ocean; thence southerly along the statutory beach line of the Pacific Ocean to the north line of SW 95th Street; thence east along the north line of SW 95th Street to its intersection with US 101; thence south along the west line of US 101 to a point opposite the south line of SE 98th Street; thence east across US 101 to the southeast corner of the intersection of US 101 and SE 98th Street, such point being coterminous with the Wolf Tree Destination Resort Site incorporated into the Newport Urban Growth Boundary pursuant to City of Newport Ordinance No. 1520; thence southerly, easterly, northerly, and westerly around the perimeter of the Wolf Tree Destination Resort Site to a point at the northeast corner of the intersection of SE 98th Street and US 101; thence north along the east line of US 101 to its intersection with SW Naterlin Drive; thence north and east along the south line of SW Naterlin Drive to SW Bay Street; thence south and east along the south line of SW Bay Street to the Mean Higher High Water (MHHW) line of Yaquina Bay; thence easterly and northerly along the MHHW line to its intersection with the Newport Urban Growth Boundary; thence northerly along the Urban Growth Boundary line to the south line of the Yaquina Bay Road; thence west along the south line of the Yaquina Bay Road to the point where it transitions into SE Bay Boulevard; thence west along the south line of SE Bay Boulevard to SE Moore Drive; thence north and west along the east line of SE Moore Drive to US 20; thence west along the south line of US 20 to the west line of SE Grant Street; thence north across US 20 to the west line of NE Grant Street; thence north along the west line of NE Grant Street to NE 1st Street; thence west along the north line of NE 1st Street to US 101; thence north along the east line of US 101 to the north line of NE 12th Street; thence west across US 101 to the point of beginning.

14.25.025 Allowed Locations

- A. Home share and Bed & Breakfast Facility use of a dwelling unit is permitted in all residential and commercial zone districts.
- B. Vacation rental use of a dwelling unit is permitted within the Vacation Rental Overlay Zone.

14.25.030 Approval Standards

- A. Spacing. Vacation rental use shall be limited to a single building on a lot, or group of lots, that abut a street segment. All dwelling units contained within the building are eligible for vacation rental use. For buildings on corner lots, this standard applies to both street segments.
- B. Occupancy. Maximum occupancy for a short-term rental shall be two (2) persons per bedroom, plus two additional persons per property.
- C. Guestroom Limitations. The following limitations apply to the number of bedrooms within a dwelling unit that may be occupied by guests staying at a short-term rental.
 - 1. Vacation Rentals and Bed and Breakfast Facilities. A maximum of five (5) guest bedrooms.
 - 2. Home shares. A maximum of two (2) bedrooms.
- D. Parking Standards. One (1) off-street parking space per bedroom that is dedicated to short-term rental use, unless the dwelling unit is within a parking district as defined in section 14.14.100, in which case on-street parking may be used to meet the one (1) space per bedroom requirement provided the parking is allocated in accordance with the requirements of the parking district. Parking spaces shall comply with the dimensional standards of subsection 14.14.090(A). Off-street parking on driveways that extend into underdeveloped rights-of-way may be used to satisfy this requirement provided a stipulation is placed on the endorsement that the authorization may be revoked if the street is improved and driveway shortened.
- E. Shared Access. Short-term rentals that rely upon use of shared access and parking areas may only be permitted if a covenant or other binding legal instrument establishes that the owner of the unit maintains exclusive use of the required parking space(s).

- F. Landscaping. For short-term rentals situated on individual lots or parcels in residential zones, at least 50% of the front yard and 40% of the total area shall be landscaped. No more than 50% of the front yard landscaping may be impervious surfaces, such as patios and decks. Driveway and parking areas shall not satisfy any portion of these landscaping requirements.

14.25.035 Non-Conforming Short-Term Rentals

- A For bed and breakfast facilities and home shares, the non-conforming use provisions of NMC Chapter 14.32 shall apply to dwelling units licensed by the city prior to the effective date of this ordinance.
- B. For vacation rentals, the non-conforming use provisions of NMC Chapter 14.32 shall apply to dwelling units licensed by the city prior to the effective date of this ordinance for a period of five (5) years, after which the dwelling units shall comply with all applicable provisions of this chapter, except:
 - 1. Vacation rentals in areas where the Vacation Rental Overlay Zone identifies vacation rental use as permissible. Such non-conforming vacation rentals may continue pursuant to the provisions of NMC Chapter 14.32.